

INDUSTRIAL FITTINGS - couplings

Lever couplings FERRARI

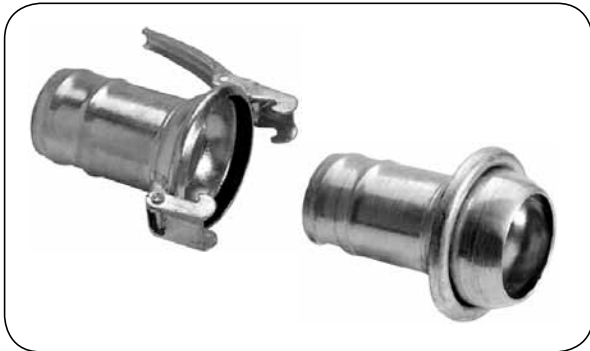

Material: Galvanized steel
Seal: NR-SBR
Working press.: 10 bar - sizes 48, 60 mm
 9 bar - size 80 mm
 8 bar - size 100 mm
 7 bar - size 120 mm
 6 bar - size 150 mm
Working temp.: From -20°C up to +50°C

FERRARI couplings (pipes and fittings) are widely used in farming, gardening, industry, construction, road and tunnel building, groundwater drainage, sewage treatment plants, wastewater disposal and environmental engineering. Coupling design allows angular deflection of the connected coupling (max. 26° in small sizes, 20° in big sizes). Available in a wide pipe diameter range (48, 60, 80, 100, 120, 150 mm), as a version with three hooks (for higher working pressure) and made of AISI 304 steel.

| Plug end cap | |
|--------------|------|
| | |
| F.5B | |
| code | size |
| OM-F5B-048 | 48 |
| OM-F5B-060 | 60 |
| OM-F5B-080 | 80 |
| OM-F5B-100 | 100 |
| OM-F5B-120 | 120 |
| OM-F5B-150 | 150 |

| Socket end cap | |
|----------------|------|
| | |
| F.6B | |
| code | size |
| OM-F6B-048 | 48 |
| OM-F6B-060 | 60 |
| OM-F6B-080 | 80 |
| OM-F6B-100 | 100 |
| OM-F6B-120 | 120 |
| OM-F6B-150 | 150 |

| Reducing socket with hose tail | | |
|--------------------------------|------|----------------|
| | | |
| F.10 | | |
| code | size | hose I.D. [mm] |
| OM-F10-060-050 | 60 | 50 |
| OM-F10-060-063 | 60 | 63 |
| OM-F10-080-060 | 80 | 60 |
| OM-F10-080-076 | 80 | 76 |
| OM-F10-100-080 | 100 | 80 |
| OM-F10-100-090 | 100 | 90 |
| OM-F10-100-102 | 100 | 102 |
| OM-F10-120-100 | 120 | 100 |
| OM-F10-120-125 | 120 | 125 |

| Reducing plug with hose tail | | |
|------------------------------|------|----------------|
| | | |
| F.11 | | |
| code | size | hose I.D. [mm] |
| OM-F11-060-050 | 60 | 50 |
| OM-F11-060-063 | 60 | 63 |
| OM-F11-080-060 | 80 | 60 |
| OM-F11-080-076 | 80 | 76 |
| OM-F11-100-080 | 100 | 80 |
| OM-F11-100-090 | 100 | 90 |
| OM-F11-100-102 | 100 | 102 |
| OM-F11-120-100 | 120 | 100 |
| OM-F11-120-125 | 120 | 125 |